



## Roteador Mercusys AC12G

Cada vez mais dispositivos utilizam o padrão ac, podendo assim oferecer desempenho Wi-Fi em seu pleno potencial. Com sua velocidade wireless, o Mercusys AC12 é a escolha superior para Wi-Fi mais rápido.





For more information, please visit our website:  
<http://www.mercusys.com>  
 7107500059 REV1.0.0

## Quick Installation Guide

AC12  
 AC1200 Dual Band Wireless Router

### 1 | Connect the Hardware

Note: If your Internet connection is through an Ethernet cable from the wall instead of through a DSL/Cable/Satellite modem, connect the Ethernet cable directly to the router's WAN port.

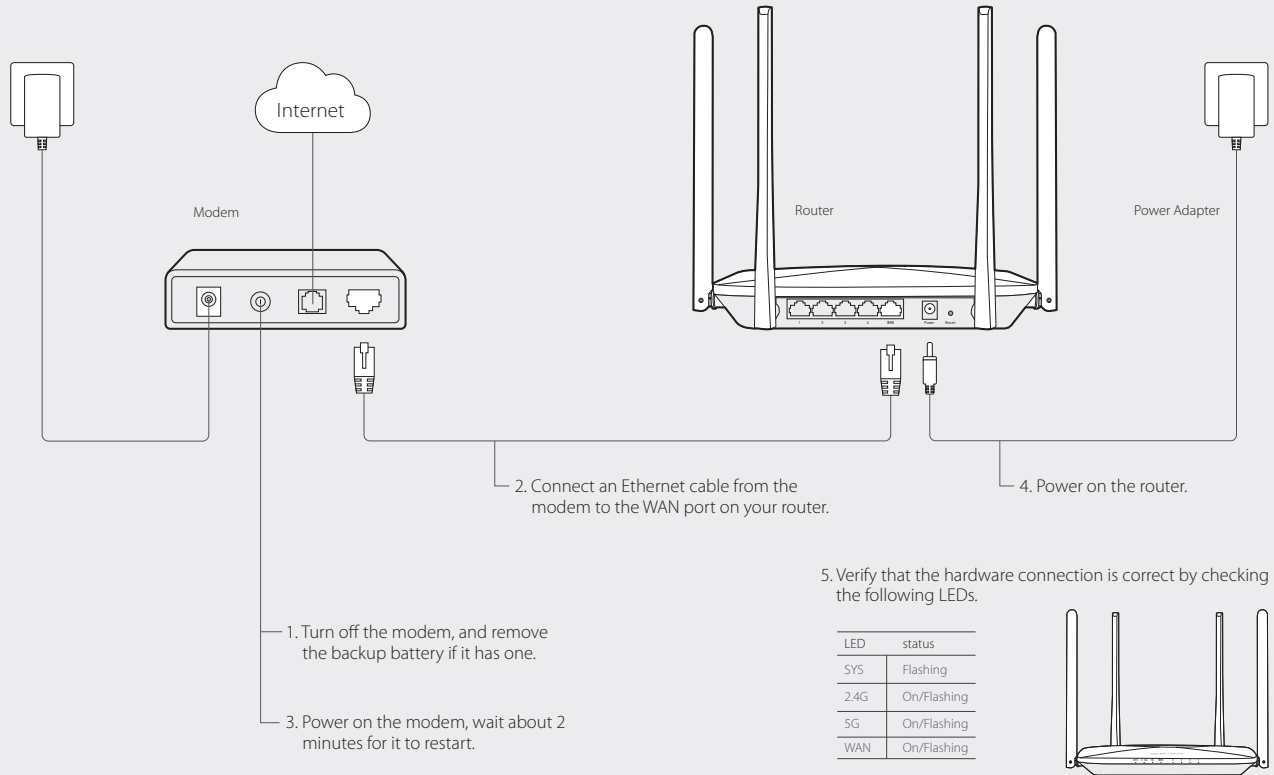

### 2 | Configure the Router

1 Connect your computer to the router (Wired or Wireless).

#### Wired

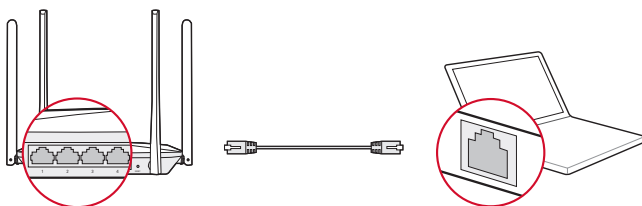

#### Wireless

Connect wirelessly using the SSID (Network Name) printed on the product label at the bottom of the router.

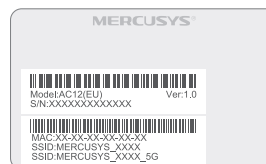

**2** Configure the router using a web browser.

a. Enter <http://mwlogin.net> in the address bar of the web browser. Create a login password when prompted.

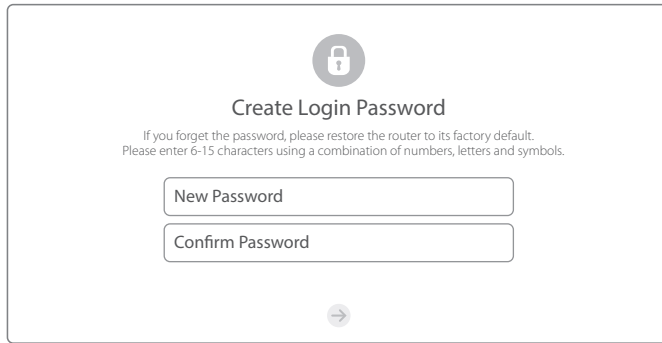

Note: If the login window does not appear, please refer to FAQ>Q1.

b. Select your connection type and enter the corresponding parameters. If you are unsure of your connection type, click **Auto-Detect**. Here we use PPPoE as an example.



c. Customize your wireless network name and password.

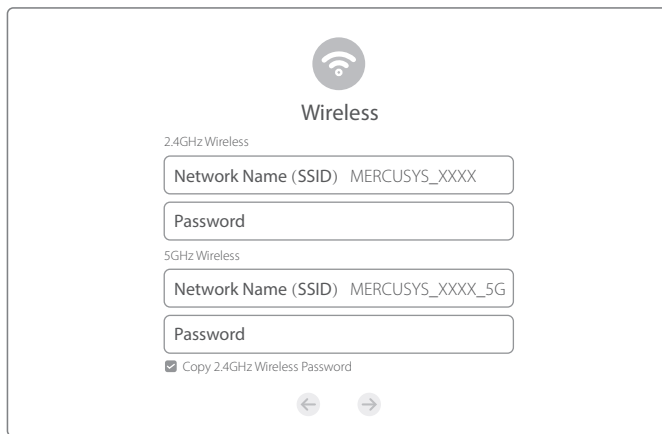

d. Click to complete the setup. Then you can enjoy the Internet!

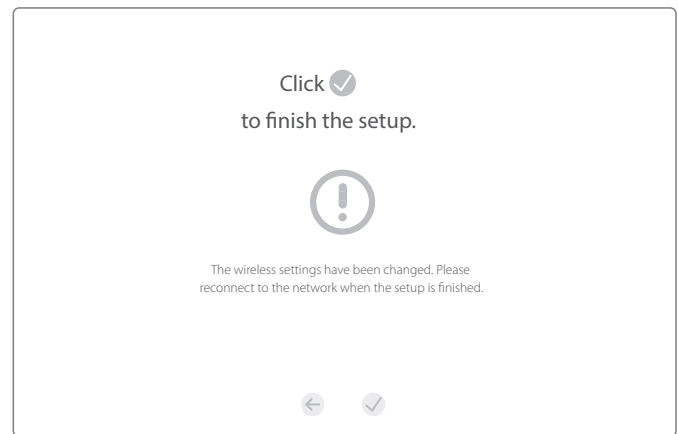

## LED Indicators

LED	Status	Indication
SYS	Off	Power is off.
	Flashing	The router is working properly.
2.4G	Off	2.4GHz/5GHz wireless is disabled.
	On	2.4GHz/5GHz wireless is enabled.
5G	Off	2.4GHz/5GHz wireless is disabled.
	Flashing	2.4GHz/5GHz wireless is transmitting/receiving data.
WAN	Off	The corresponding port is not connected.
	On	The corresponding port is connected.
4/3/2/1	Flashing	The corresponding port is transmitting/receiving data.

## FAQ (Frequently Asked Questions)

### Q1. What can I do if the login window does not appear?

- A1. If the computer is set to a static IP address, change it to obtain an IP address automatically.
- A2. Verify that <http://mwlogin.net> is correctly entered in the web browser.
- A3. Use another web browser and try again.
- A4. Reboot your router and try again.
- A5. Disable the network adapter used currently and then enable it again.

### Q2. What can I do if I cannot access the Internet?

- A1. Check if the Internet is working properly by connecting a computer directly to the modem via Ethernet cable.  
If not, contact your Internet Service Provider.
- A2. Open a web browser, enter <http://mwlogin.net> and try to set up again.
- A3. Reboot your router and try again.

Note: For cable modem users, reboot the modem first. If the problem still exists, log in to the web management page, go to **Advanced>Network>MAC Address Settings**, select **Use the current computer's MAC address (MAC Clone)** and **Save**.

### Q3. How do I restore the router to its factory default settings?

- A1. With the router powered on, press and hold the Reset button on the rear panel for approximately 8 seconds until all the LEDs turn on temporarily.
- A2. Log in to the web management page of the router, and go to **Advanced>System Tools>Factory Default Restore**, click **Restore**, then wait until the process completes.

### Q4. What can I do if I forget my web management page password?

- A. Restore the router to its factory default settings and then create a new password when prompted.

### Q5. What can I do if I forget my wireless network password?

- A1. By default, the wireless network has no password.
- A2. If you have set password for the network, log in to the router's web management page, go to **Basic>Wireless** to obtain or reset your password.